

Model ZLP1

Compact, powerful, and easy to use

ZLP1 is a cost effective entry to laser projection. It is the smallest laser projector in the Z-LASER ZLP family.

ZLP1 is directed to 2D and 3D applications like pick-and-place, logistics and workstations. Enlarge and optimize your production or workflow by this easy to use laser projection system. ZLP1 is eye-safe (laser class 2M) and optimized for smaller working areas and shorter working distances.

We offer our own software ZLP-Suite, which has an intuitive software interface with many customizable options and as a result customers can adapt the settings according to their specific application. Furthermore, ZLP-Suite can be upgraded with additional software modules. Thanks to its numerous connectivity options the laser projector can be operated through various software interfaces such as C++, C# or Python.

Ask Z-LASER for OEM integration.

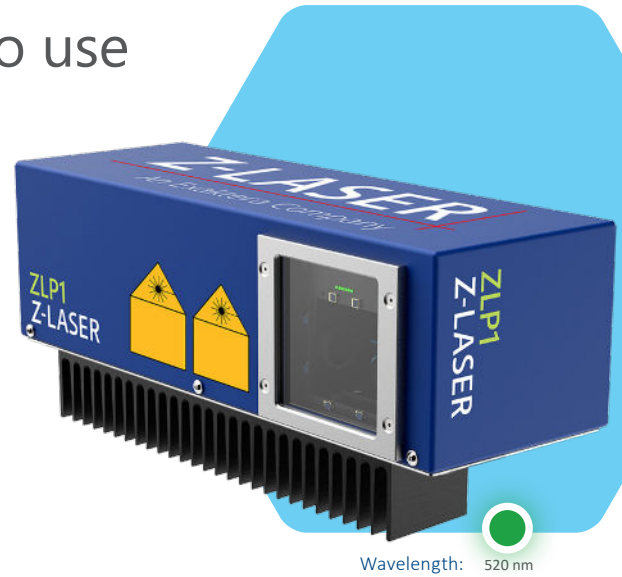

Intuitive software



Optical angle 60°



Optimized for 2D and 3D projection



Integration into multiprojector systems



Active or passive cooling system



IP54

Highlights

- Cost-effective laser projection system
- Easily operable via a variety of software interfaces
- Projection of 2D and 3D objects
- Optimized for interactive learning applications and workstations
- Easy integration into multi projection systems
- Data transmission via ethernet
- Passive or active cooling

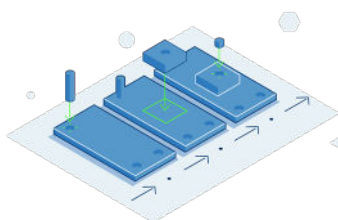

Assembly Assistance

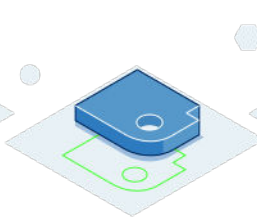

Put-to-Light

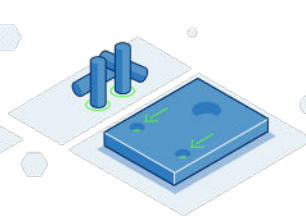

Pick-and-Place

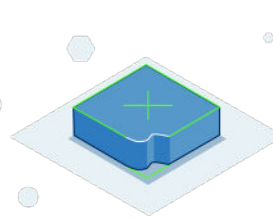

Quality Control

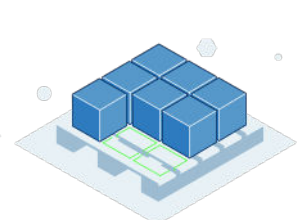

Logistics

System specifications

Laser source	Green laser diode
Wavelength	520 nm
Output power	5 mW
Laser class (on EN 60825)	2M
Fan angle	60° x 60°
Accuracy ⁽¹⁾ ((For working distances of 1-3 m)	± 3 mm
Working distance (fixed focus at 2 m)	1 m up to 3 m
Frequency of projection	Max. 50 Hz (depends on the projection)
Weight	3.4 kg (plus ca. 1.4 kg for separate power supply)
Dimensions (L x W x H)	314 x 111 x 96 mm (137 mm incl. fan) 12.36 x 4.37 x 3.77 in (5.39 incl fan)
IP protection class	IP54

Software / handling

Software	ZLP-Suite
SDK	C++, C#, Python
Graphics format	DXF / HPGL / HPGL 3D

Accessories

Optional accessories	Remote control, power supply, glass reflectors, mounting
----------------------	--

Electrical specifications

Operating voltage	24 VDC ±10%
Protection class electrical	3 (protective low voltage)
Interfaces	Ethernet TP
Power consumption (typical)	<40 W RMS (max. 70W)

Ambient Conditions

Operating condition	+5 °C up to +40 °C (with passive cooling) +5 °C up to +45 °C (with active cooling)
Storage temperature	-5° C up to +60 °C
Humidity (max.)	< 80% relative, non-condensing

Distance to the projection surface (in mm)	Projection surface with an opening angle of 60° (in mm)
1.000	1.155 x 1.155
1.500	1.732 x 1.732
2.000	2.309 x 2.309
2.500	2.887 x 2.887
3000	3464 x 3464